

Effortlessly hang your art and much more...



Refresh your
walls with ease



- No nails, no tools, no mess!
- Removable and repositionable up to 5 times

StickY-
Tile™

FITTING INSTRUCTIONS

Follow carefully as one side of adhesive is permanent.

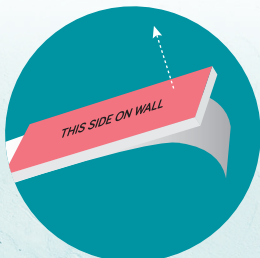

1. Clean wall, peel off adhesive pad from long backing strip

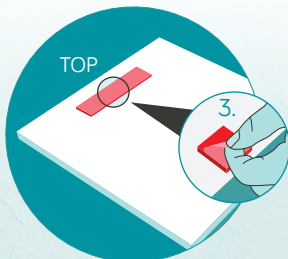

2. Place the exposed adhesive on the back as shown
3. Remove the backing from adhesive pads



4. Lightly position on wall and hold for 5 seconds. **Only** push hard against the wall if initial adhesion is not held.

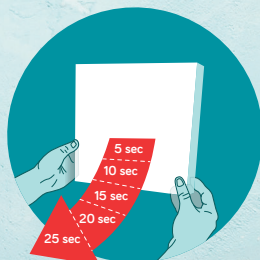

5. To reposition pull **gently** and **slowly** up from the bottom

IMPORTANT

Ideal for most wall surfaces. Not recommended for use on delaminating surfaces e.g. wallpaper.

Whilst extensive testing proves this premium repositionable adhesive, we cannot take responsibility for any damaged wall décor. We do know however that the chances of damaging your walls are extremely slim compared to using a hammer or drill!

If you have just painted your walls we recommend leaving it at least 14 days before applying the Stick It.